

LYNATET 75

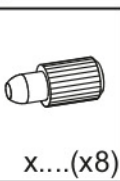

80 min

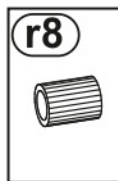

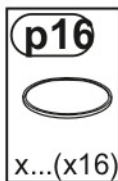
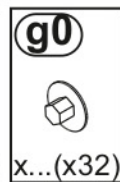
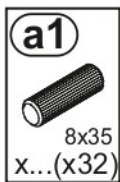
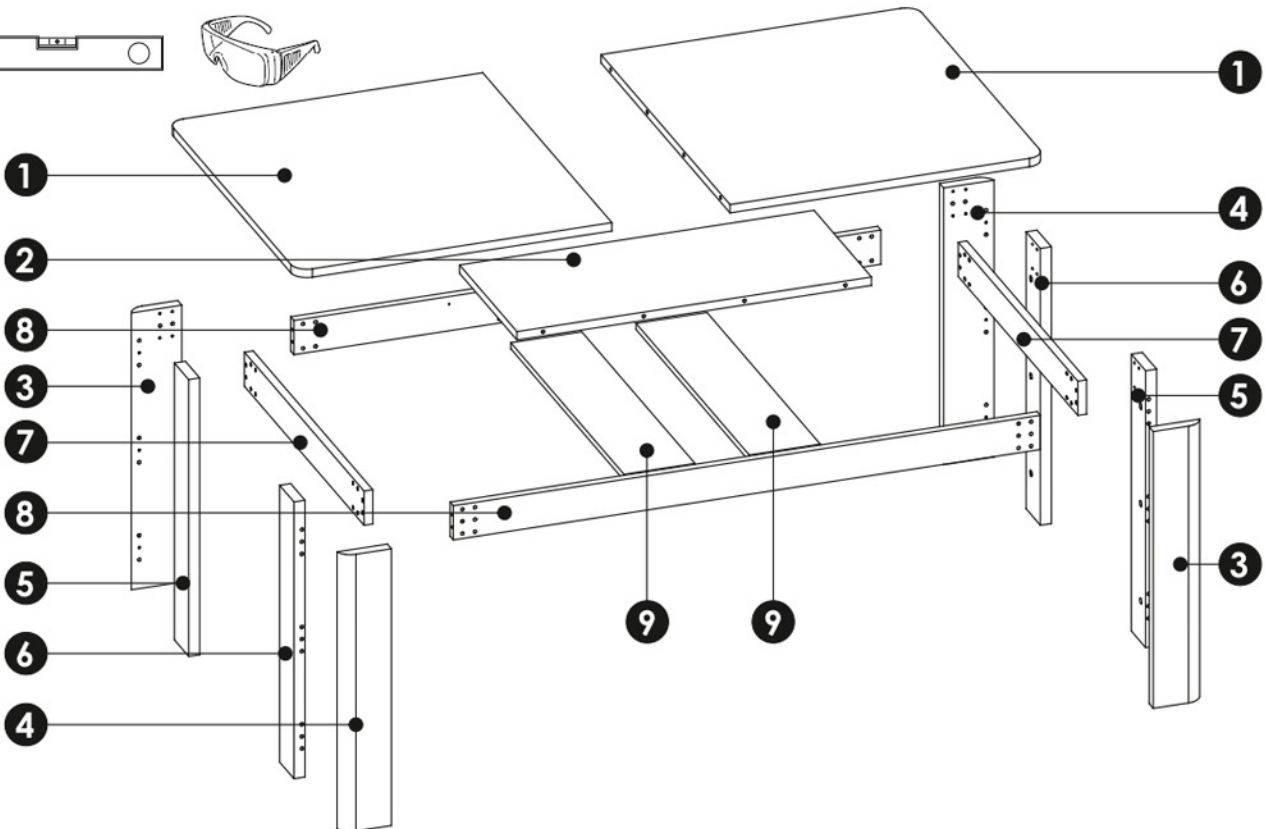
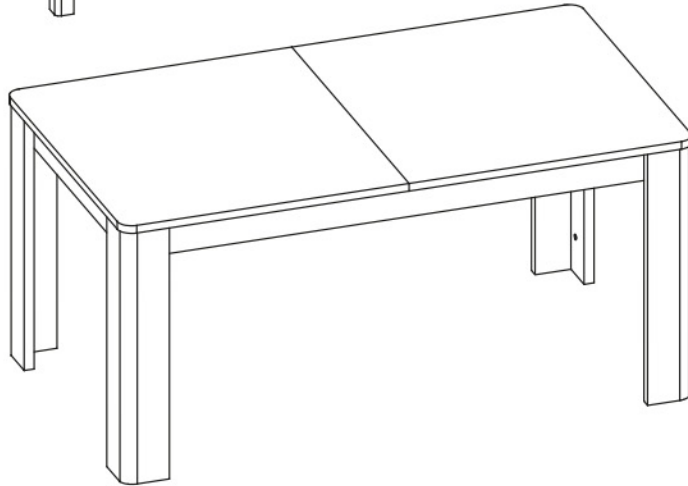
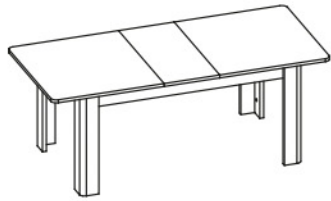
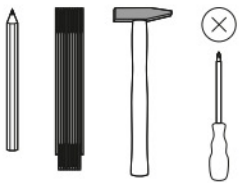
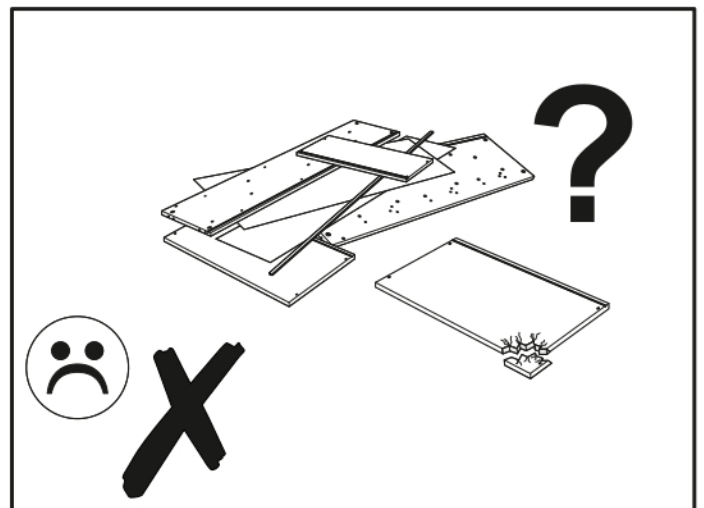
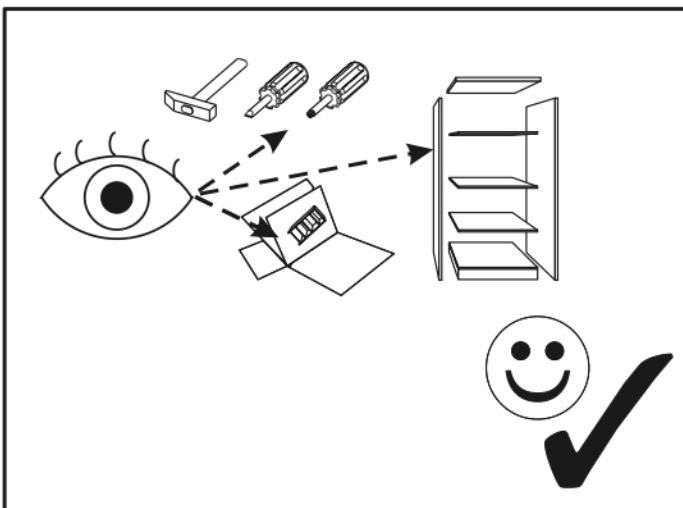
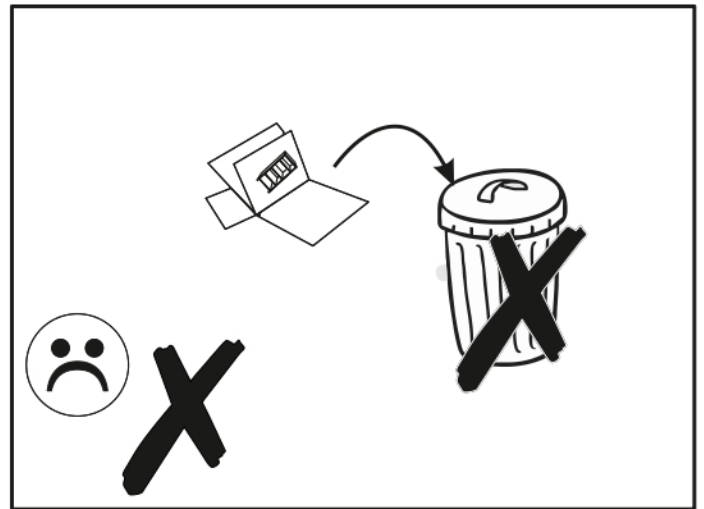
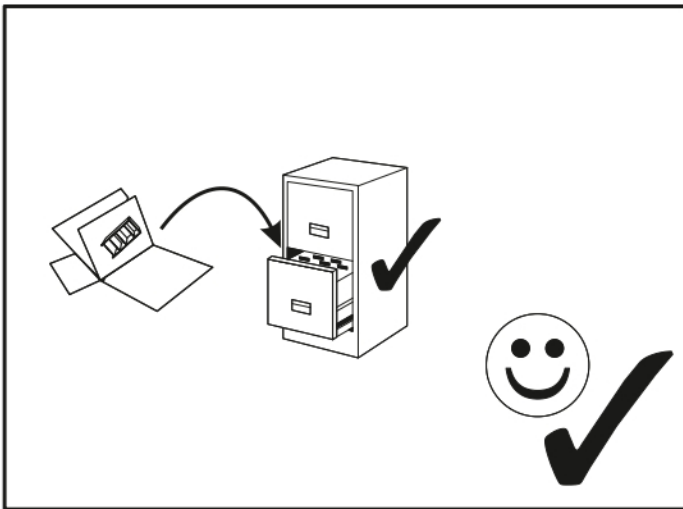
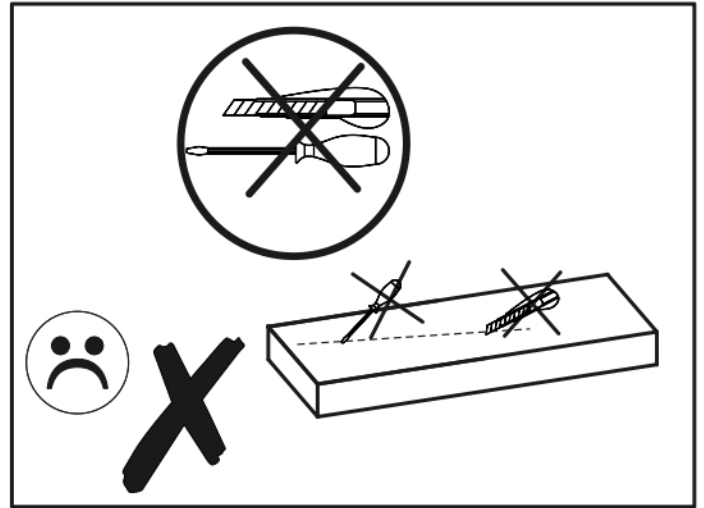
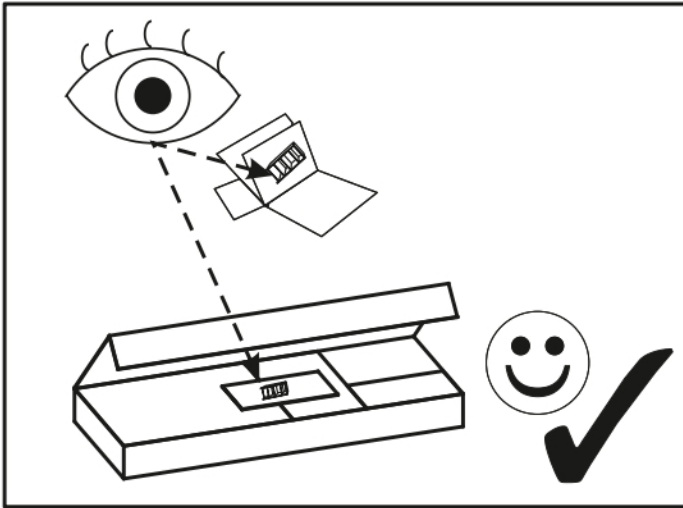

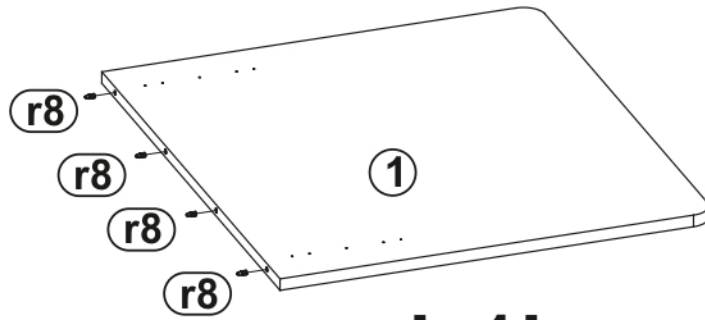
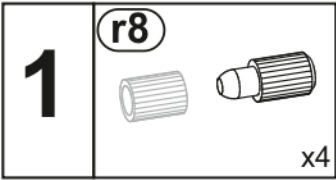

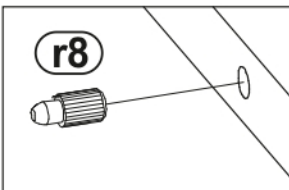
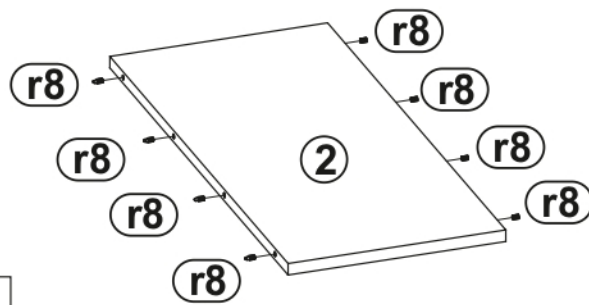
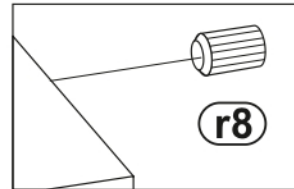
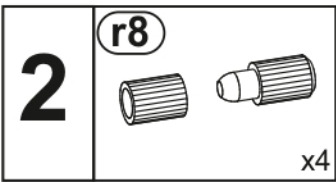
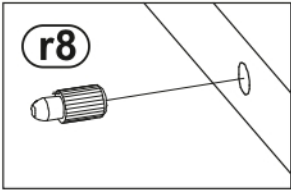

!x1!

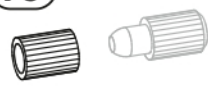

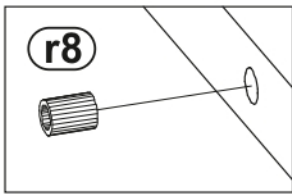
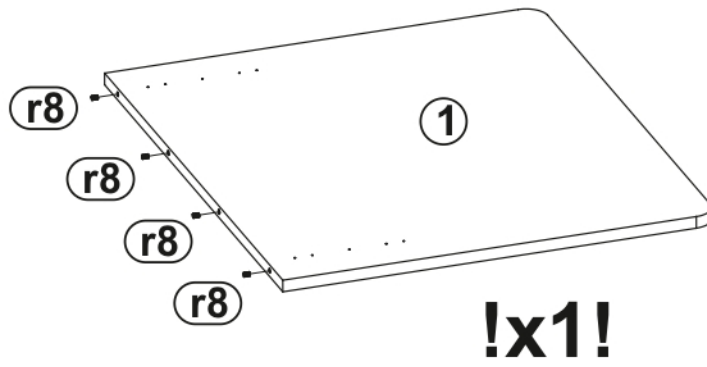
3 **r8**  x4



4 **a1** **e1**
 8x35 x8
 x4

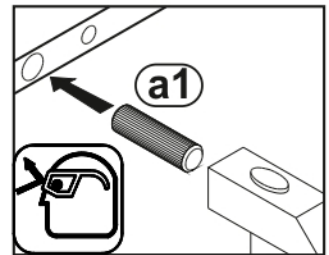
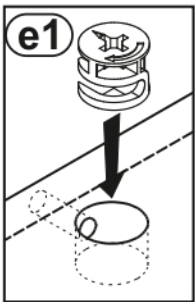
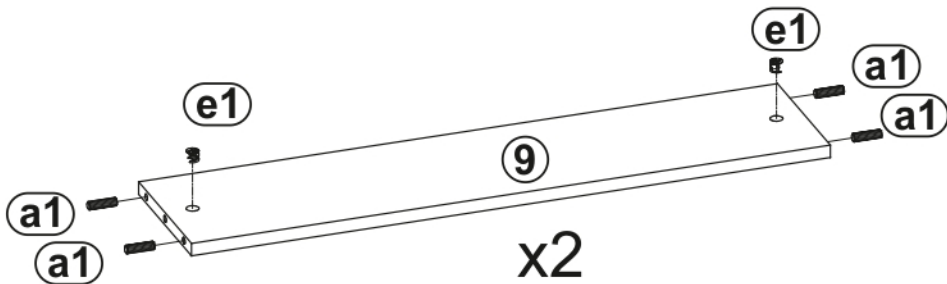

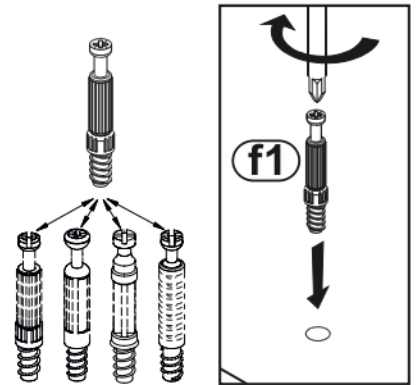
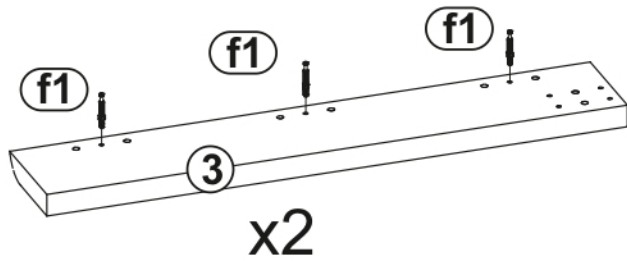

5  **f1**
x6



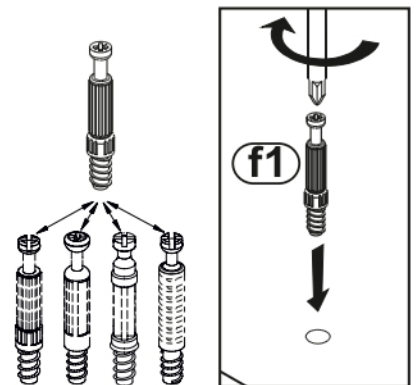
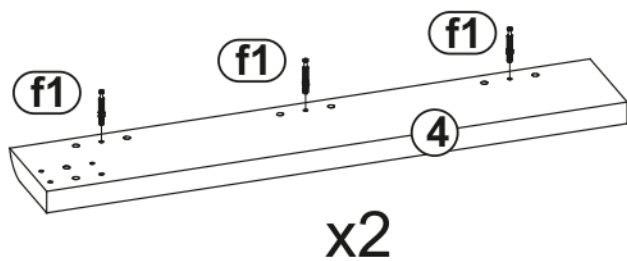

6  **f1**
x6

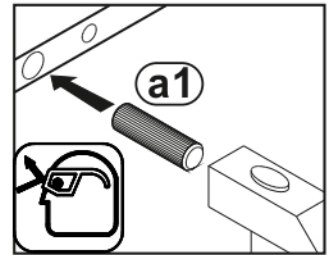
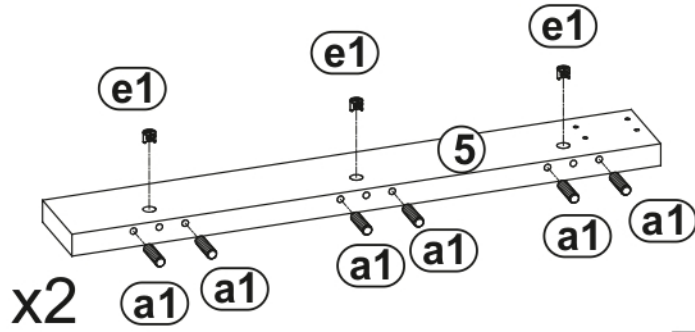
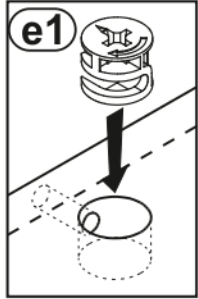

7	a1	e1
	 8x35 x12	 x6



8	a1	e1
	 8x35 x12	 x6

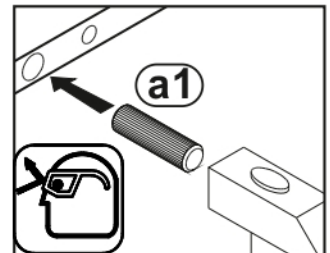
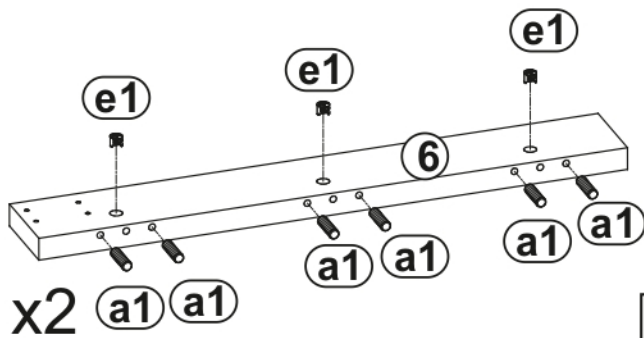
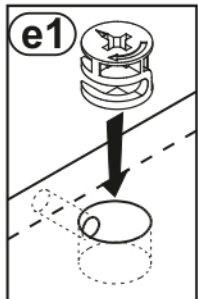

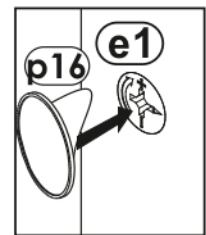
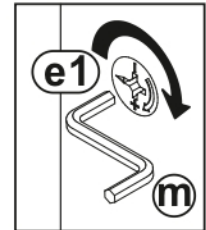
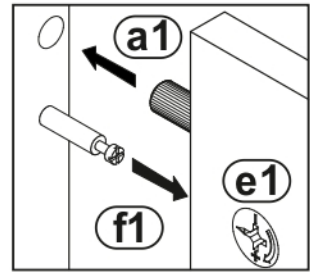
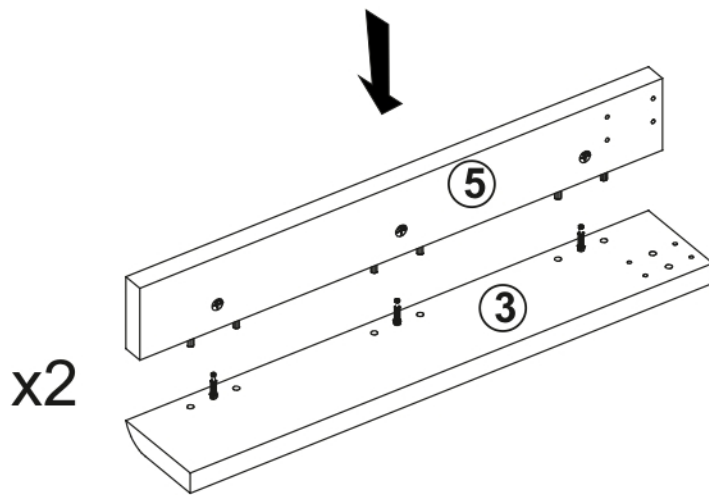

9 **p16**

x6

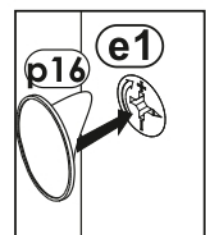
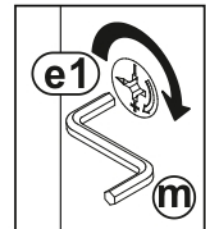
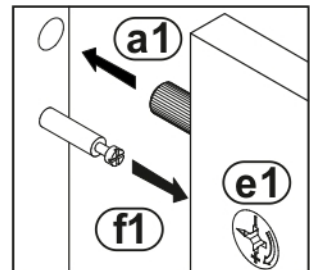
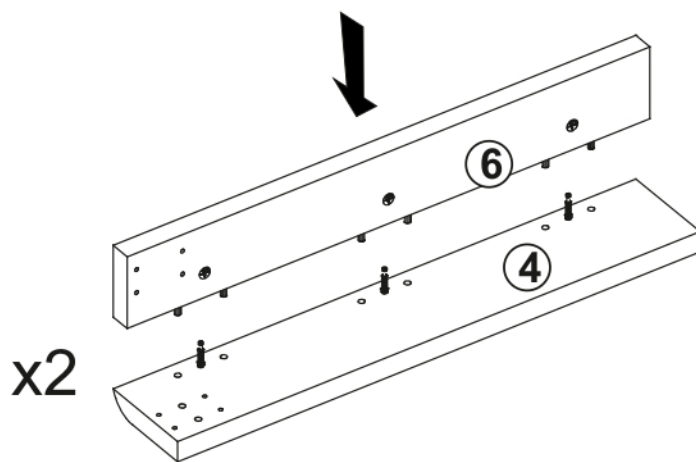

10 **p16**

x6



11

f1  x4	n2  3.5x16 x4	t14  L-750 x2
---	---	--

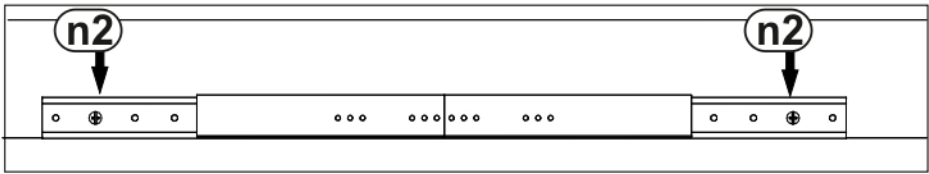
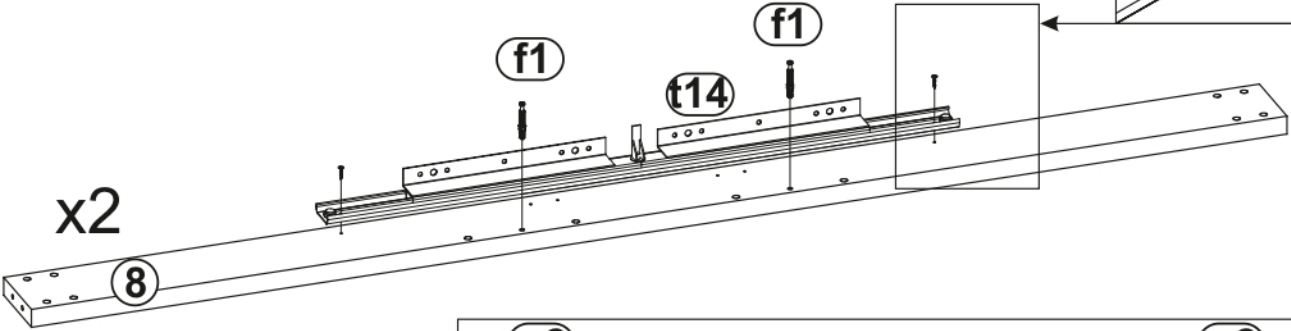
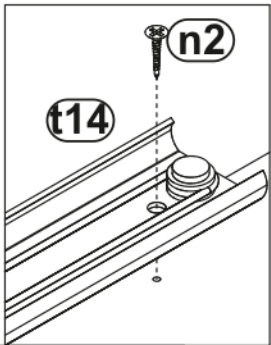
P8/15



12

n2  3.5x16 x8
--

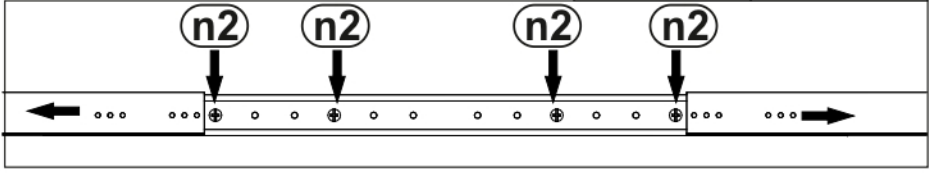
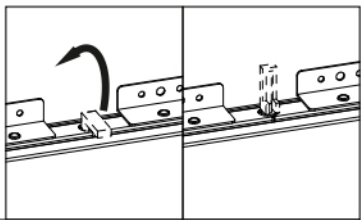
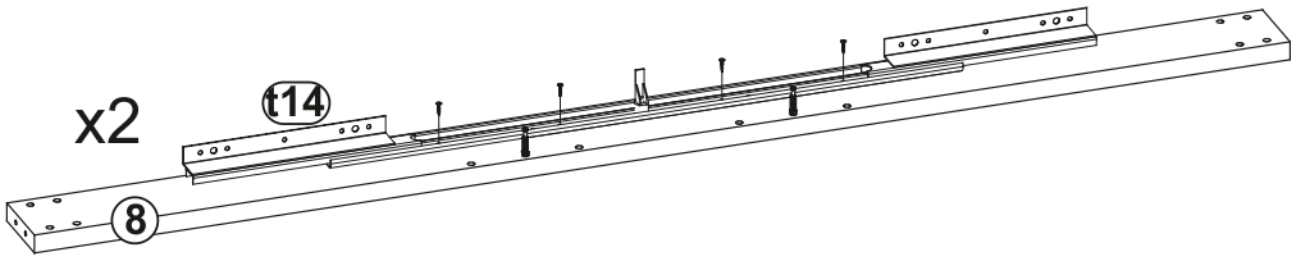

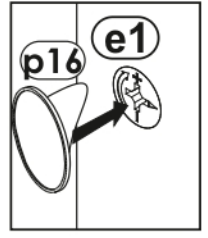
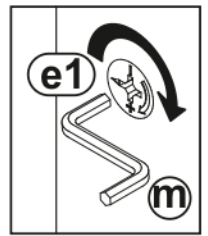
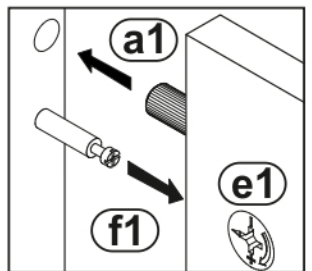
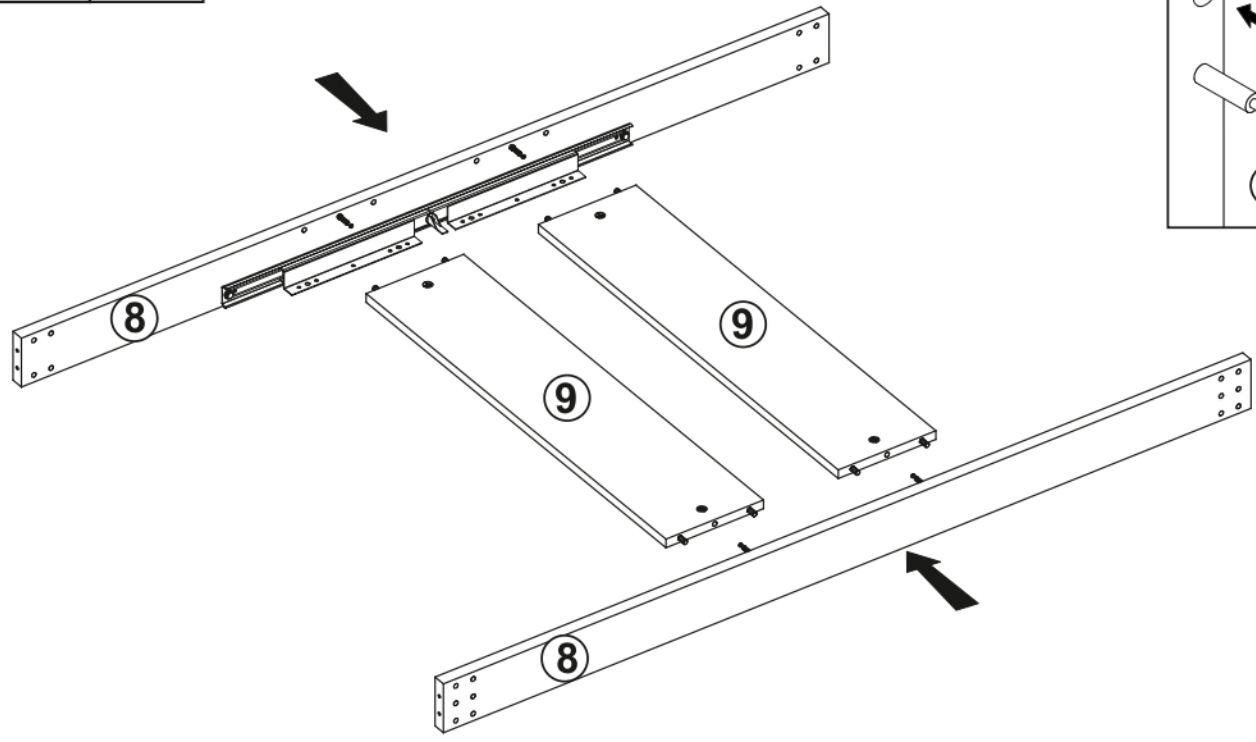

13 **p16**

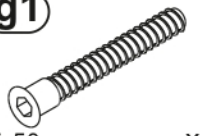
 x4

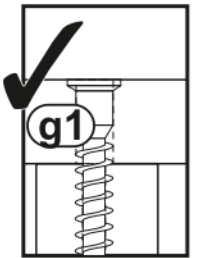
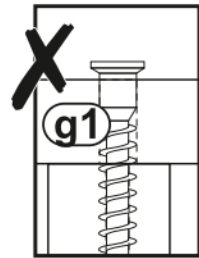
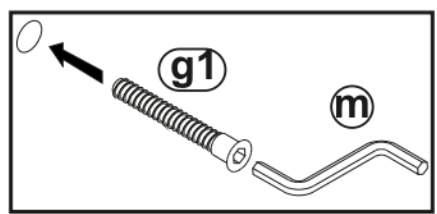
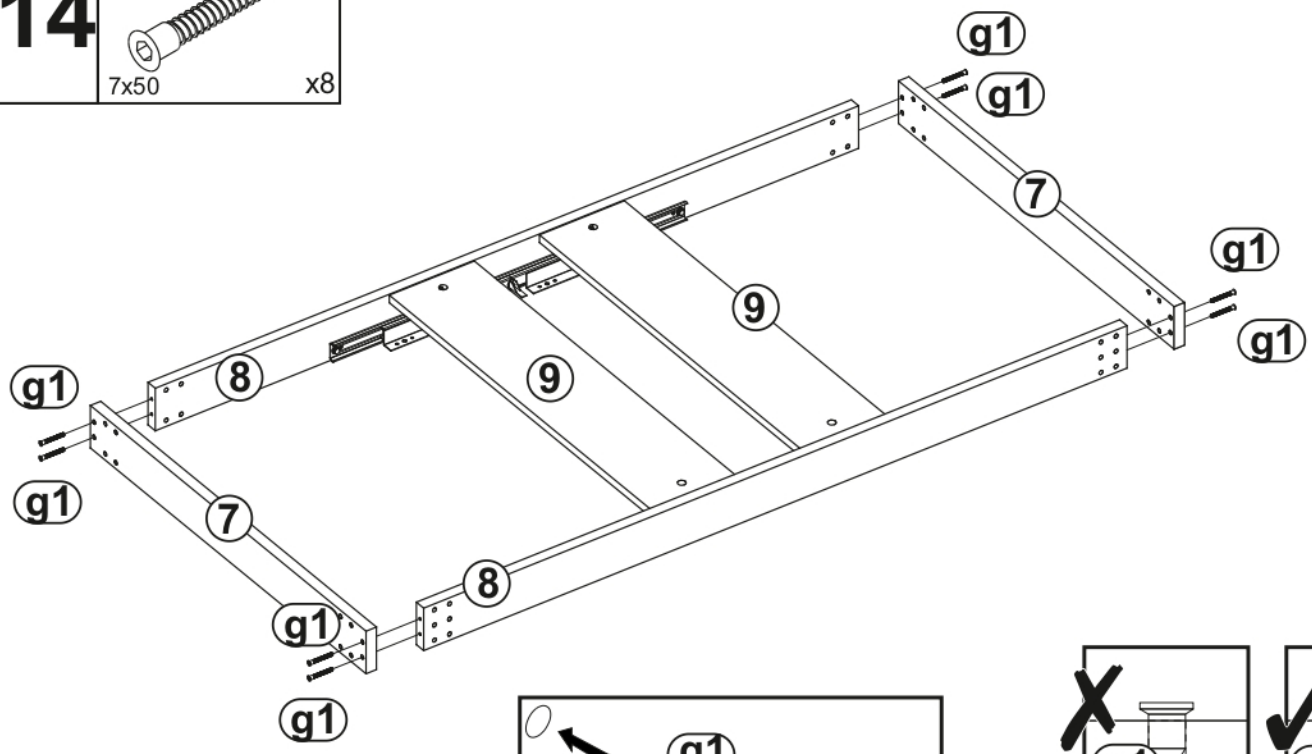

14 **g1**

 7x50 x8

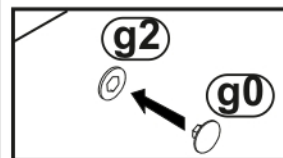
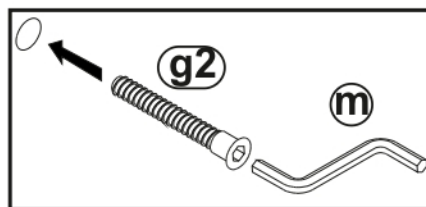
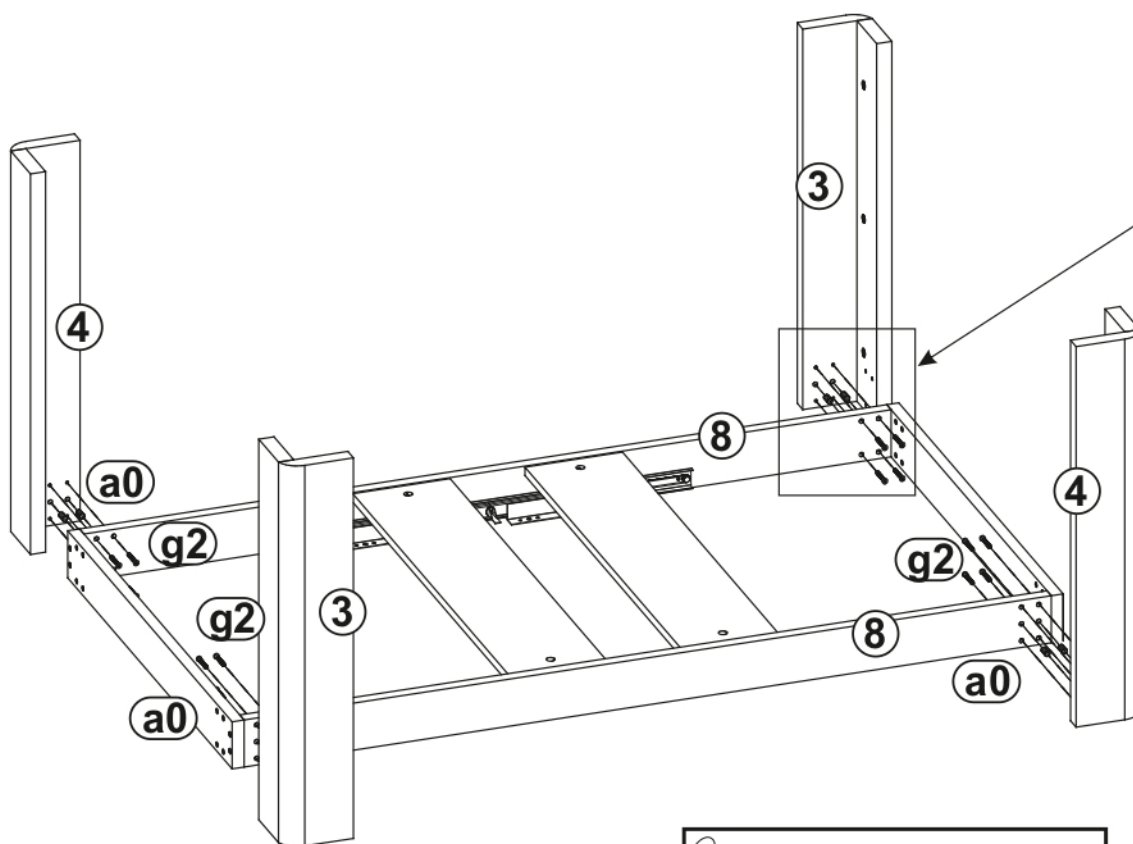
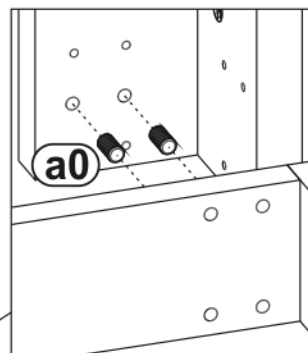
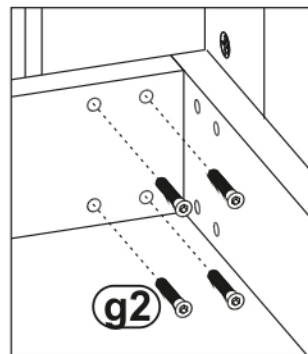
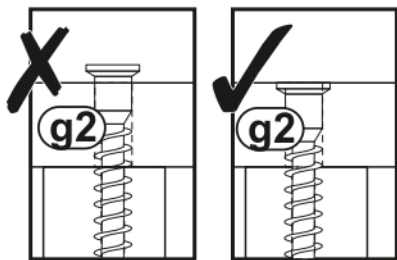

15

a0  8x35 x8	g0  x16	g2  7x60 x16
--	---	--



18

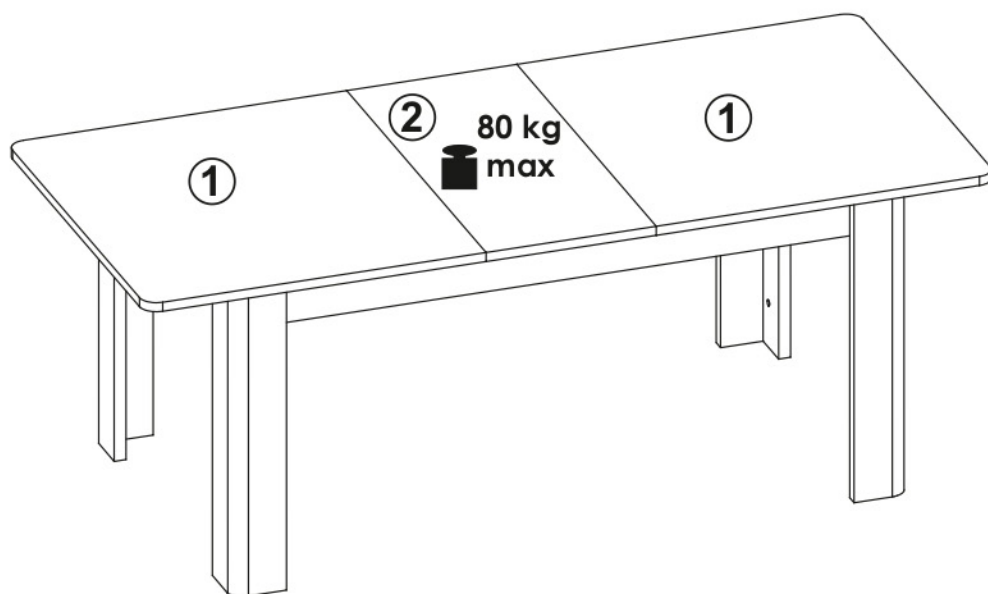
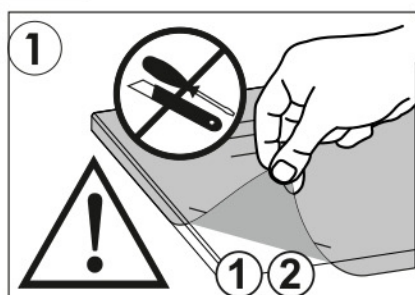

19

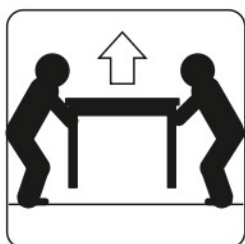
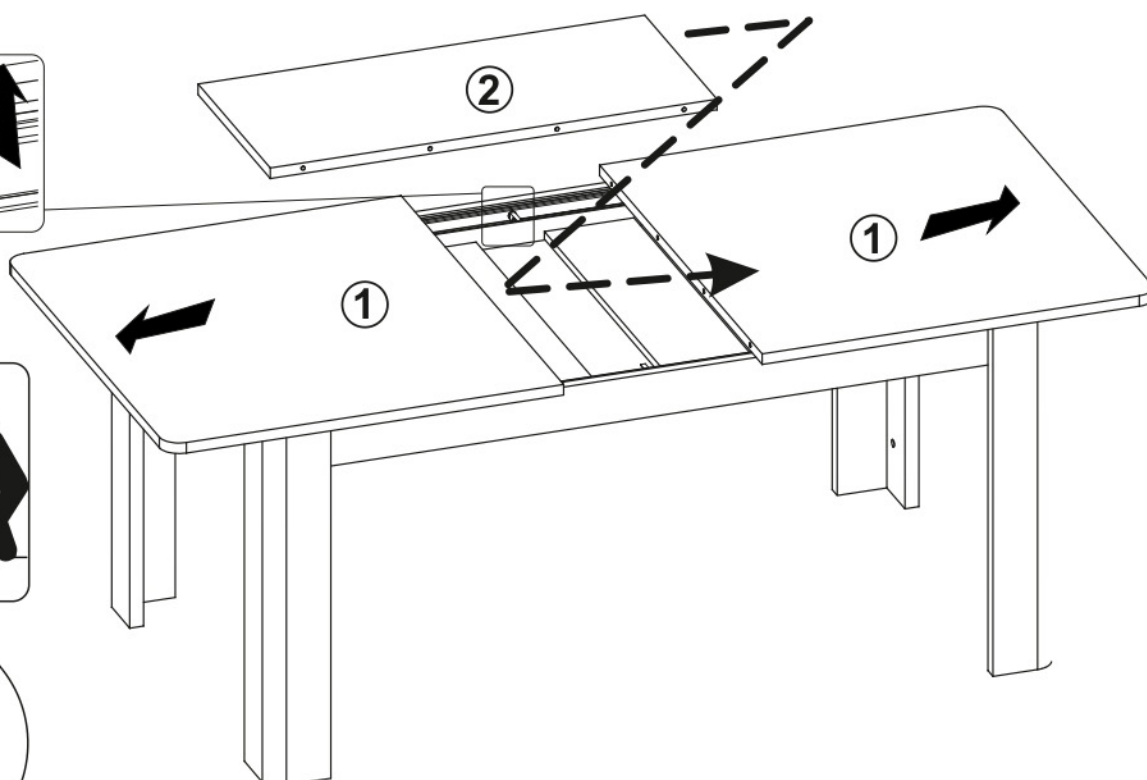
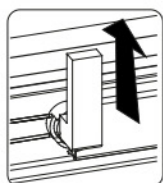

MOBILIERUL CARE CONȚINE PLĂCI PE BAZĂ DE LEMN (PLĂCI DE FURNIR, PLĂCI DIN FIBRĂ DE LEMN, AGLOMERAT ETC.) POATE ELIBERA SUBSTANȚE POLUANTE ÎN INTERIORUL LOCUINȚEI. PRIN URMARE, SE RECOMANDĂ AERISIREA PERIODICĂ A CAMEREI CORESPUNZĂTOARE TIMP DE CEL PUȚIN PATRU SĂPTĂMÂNI DUPĂ INSTALAREA MOBILEI ÎN CASĂ, PENTRU A REDUCE EXPUNEREA LA SUBSTANȚELE POLUANTE EMISE DE MOBILĂ.

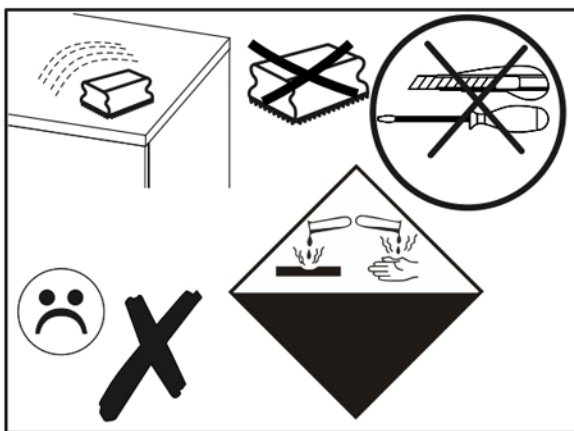
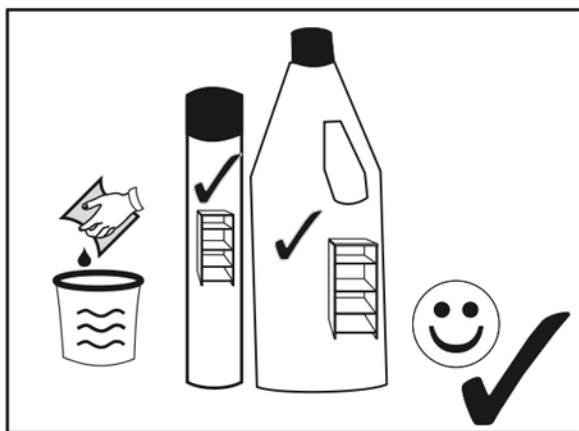
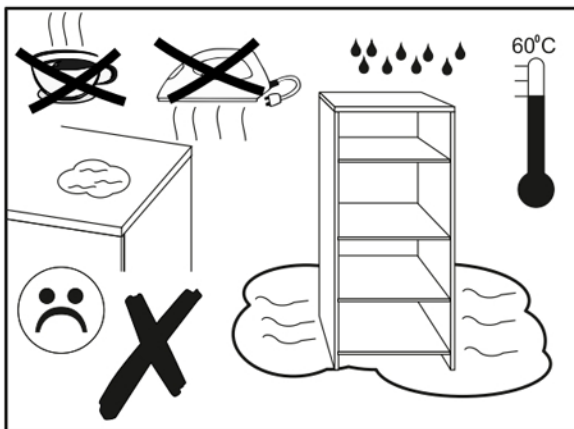
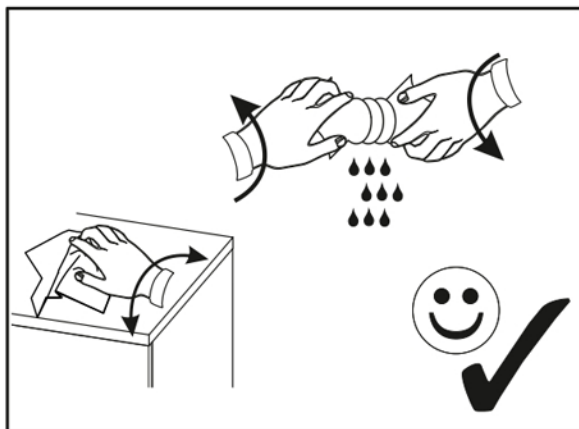
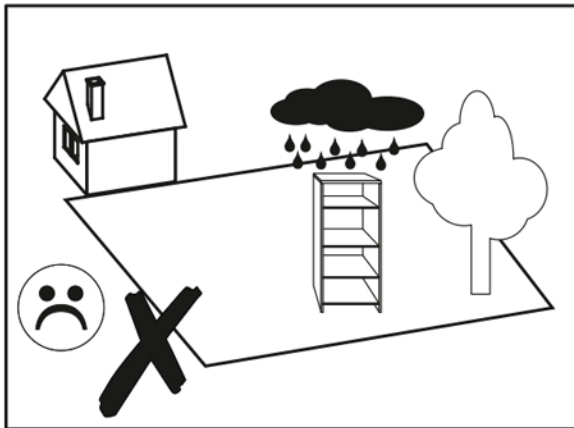
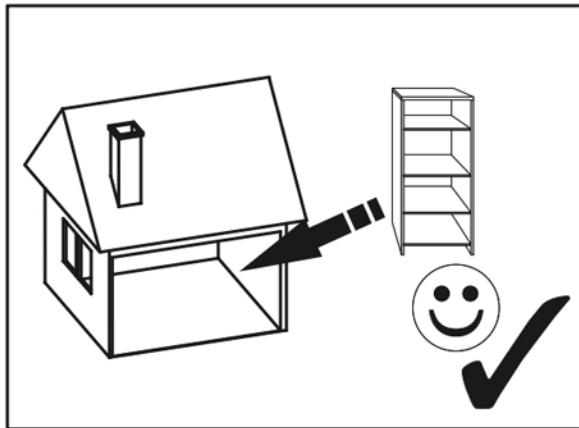

INSTRUCȚIUNI DE ASAMBLARE:

- 1 > CITIȚI CU ATENȚIE INSTRUCȚIUNILE DE ASAMBLARE.
- 2 > IDENTIFICAȚI COMPONENTELE MOBILEI.
- 3 > NUMĂRAȚI ȘI VERIFICAȚI COMPONENTELE.
- 4 > UTILIZAȚI INSTRUMENTELE NECESARE.
- 5 > CREAȚI O ZONĂ DE ASAMBLARE.
- 6 > REALIZAȚI ASAMBLAREA.

LA ASAMBLARE, EVITAȚI APLICAREA UNEI FORȚE EXCESIVE. REVENIȚI DUPĂ CÂTEVA ZILE ȘI STRÂNGEȚI DIN NOU ȘURUBURILE. PĂSTRAȚI CU GRIJĂ BROȘURA CARE ÎNSOȚEȘTE PRODUSUL, CONȚINE INFORMAȚII PENTRU SOLICITAREA, PE VIITOR, A EVENTUALELOR PIESE LIPSĂ.

INSTRUCȚIUNI DE ÎNTREȚINERE:

- 1 > ÎNDEPĂRTAȚI CU GRIJĂ PRAFUL.
- 2 > UTILIZAȚI O LAVETĂ MOALE, CURATĂ ȘI UMEZITĂ CU APĂ ȘI SĂPUN.

NU UTILIZAȚI NICIODATĂ PRODUSE ABRAZIVE SAU SOLVENȚI. CÂND UTILIZAȚI O LAVETĂ UMEDĂ, EVITAȚI APLICAREA UNEI PRESIUNI EXCESIVE.

	DECOR DE HÂRTIE	SUPRAFAȚĂ LAMINATĂ	SUPRAFAȚĂ LĂCUITĂ	LEMN LĂCUIT	PIELE SINTETICĂ MATERIAL TEXTIL
APĂ CU SĂPUN (SĂPUN NEUTRU)	○	○	○	○	○
APĂ CU DETERGENT		○	○		
PRODUS DE CURĂȚARE SPECIFIC					○

ACEST PRODUS ESTE DESTINAT EXCLUSIV PENTRU UZ CASNICI